



CPVC FIRE SPRINKLER FITTINGS



CPVC EXTENSIONS

-Revolutionary Patented Design

-Labor Saving

-Easy to Install

-Made in USA

-FM Approved

argco.com

CPVC FITTING

COUPLING SOCKET X SOCKET

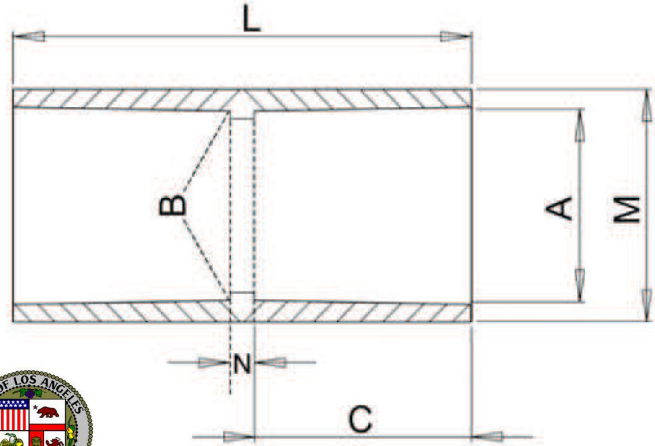

(UL Listed for up to 1")

- Pressured Rated to 175 psi @ 150°F (1200kpa @ 65°C)
- Corrosion Resistant CPVC Material Does Not Sustain Biological Growth
- Superior Flow Characteristics
- 10 Year Limited Warranty

Part Number	Size	L	N	M	Approx Wt. (Lbs.)
CPCUP-34	3/4	2-3/32	8/51	1-5/16	0.05
CPCUP-1	1	2-13/32	8/51	1-5/8	0.08
CPCUP-114	1-1/4	2-9/16	8/51	2	0.13
CPCUP-112	1-1/2	2-15/16	8/51	2-1/2	0.32
CPCUP-2	2	3-5/32	8/51	2-7/8	0.46
CPCUP-212	2-1/2	3-11/16	3/16	3-15/32	0.57
CPCUP-3	3	4	1/4	4-3/16	0.89

SOCKET DIMENSIONS

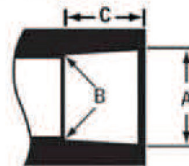

SCH 40 ASTM F438

SCH 80-ASTM F439

SIZE	Socket Ent. A	Socket Bottom B	Tolerance	SCH 40 Minimum Socket Length C	SCH 80 Minimum Socket Length C
3/4"	1.058	1.046	±0.004	0.719	1.000
1"	1.325	1.310	±0.005	0.875	1.125
1-1/4"	1.670	1.655	±0.005	0.938	1.250
1-1/2"	1.912	1.894	±0.006	1.094	1.375
2"	2.387	2.369	±0.005	1.156	1.500
2-1/2"	2.899	2.868	±0.007	1.75	1.750
3"	3.516	3.492	±0.008	1.875	1.875

System No.		Location		Spec Section		Paragraph	
Submitted By		Date		Approved		Date	

CPVC FITTING

90° ELBOW SOCKET X SOCKET

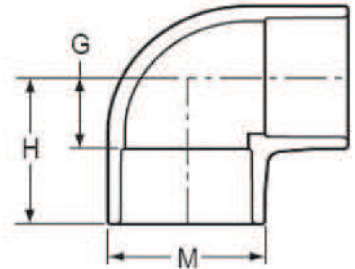
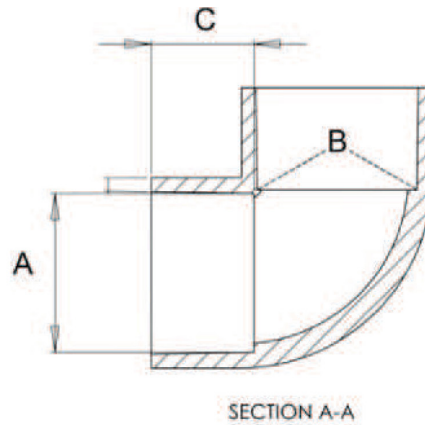

(UL Listed for up to 1")

- Pressured Rated to 175 psi @ 150°F (1200kpa @ 65°C)
- Corrosion Resistant CPVC Material Does Not Sustain Biological Growth
- Superior Flow Characteristics
- 10 Year Limited Warranty

Part Number	Size	G	H	M	Approx Wt. (Lbs.)
CP90-34	3/4	5/8	1-23/51	1-5/16	0.07
CP90-1	1	3/4	1-5/8	1-5/8	0.12
CP90-114	1-1/4	15/16	1-77/87	2	0.18
CP90-112	1-1/2	1-8/41	2-53/93	2-11/32	0.25
CP90-2	2	1-17/49	2-16/17	2-7/8	0.63
CP90-212	2-1/2	1-5/8	3- 7/16	3-7/16	1.17
CP90-3	3	1-29/32	3-23/32	4-3/16	1.80

SOCKET DIMENSIONS

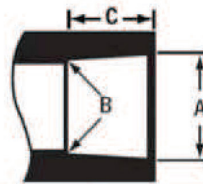

SCH 40 ASTM F438
SCH 80-ASTM F439

SIZE	Socket Ent. A	Socket Bottom B	Tolerance	SCH 40 Minimum Socket Length C	SCH 80 Minimum Socket Length C
3/4"	1.058	1.046	±0.004	0.719	1.000
1"	1.325	1.310	±0.005	0.875	1.125
1-1/4"	1.670	1.655	±0.005	0.938	1.250
1-1/2"	1.912	1.894	±0.006	1.094	1.375
2"	2.387	2.369	±0.005	1.156	1.500
2-1/2"	2.899	2.868	±0.007	1.75	1.750
3"	3.516	3.492	±0.008	1.875	1.875

System No.		Location		Spec Section		Paragraph	
Submitted By		Date		Approved		Date	

CPVC FITTING - 45° ELBOW SOCKET X SOCKET

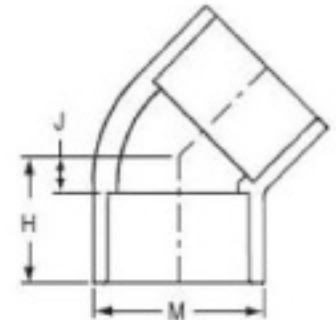
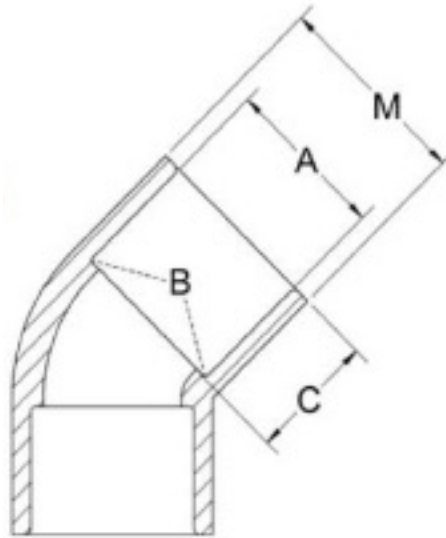

- Pressured Rated to 175 psi @ 150°F (1200kpa @ 65°C)
- Corrosion Resistant CPVC Material Does Not Sustain Biological Growth
- Superior Flow Characteristics
- 10 Year Limited Warranty



Part Number	Size	Description	Size	J	H	M	Approx Wt. (Lbs.)
CP45-34	3/4	CP45-34	3/4	15/31	1-11/47	1-13/32	0.10
CP45-1	1	CP45-100	1	17/29	1-42/83	1-25/32	0.11
CP45-114	1-1/4	CP45-114	1-1/4	39/47	1-63/76	2-3/32	0.23
CP45-112	1-1/2	CP45-112	1-1/2	15/32	1-27/32	2-11/32	0.32
CP45-2	2	CP45-200	2	21/32	2-1/8	2-7/8	0.48
CP45-212	2-1/2	CP45-212	2-1/2	15/32	1-27/32	2-11/32	0.32
CP45-3	3	CP45-300	3	21/32	2-1/8	2-7/8	0.48

SOCKET DIMENSIONS

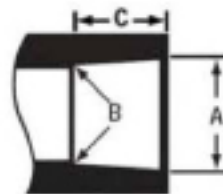

SCH 40 ASTM F438
SCH 80-ASTM F439

SIZE	Socket Ent. A	Socket Bottom B	Tolerance	SCH 40 Minimum Socket Length C	SCH 80 Minimum Socket Length C
3/4"	1.058	1.046	±0.004	0.719	1.000
1"	1.325	1.310	±0.005	0.875	1.125
1-1/4"	1.670	1.655	±0.005	0.938	1.250
1-1/2"	1.912	1.894	±0.006	1.094	1.375
2"	2.387	2.369	±0.005	1.156	1.500
2-1/2"	2.899	2.868	±0.007	1.75	1.750
3"	3.516	3.492	±0.008	1.875	1.875

System No.		Location		Spec Section		Paragraph	
Submitted By		Date		Approved		Date	

CPVC FITTING - CAP SOCKET

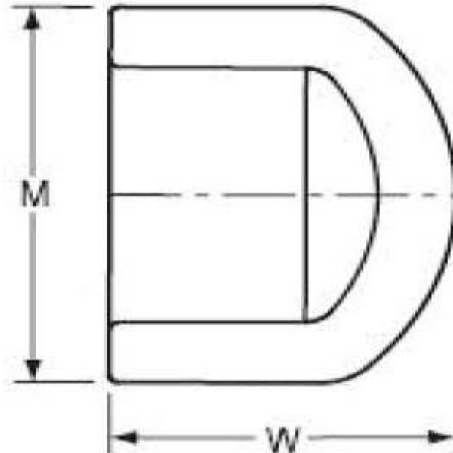

- Pressured Rated to 175 psi @ 150°F (1200kpa @ 65°C)
- Corrosion Resistant CPVC Material Does Not Sustain Biological Growth
- Superior Flow Characteristics
- 10 Year Limited Warranty



Part Number	Size	W	M	Approx Wt. (Lbs.)
CPCAP-34	3/4	1-1/4	1-3/8	0.05
CPCAP-1	1	1-1/2	1-5/8	0.06
CPCAP-114	1-1/4	1-11/16	2-3/32	0.17
CPCAP-112	1-1/2	1-13/16	2-11/32	0.18
CPCAP-2	2	2-3/16	2-27/32	0.35

SOCKET DIMENSIONS

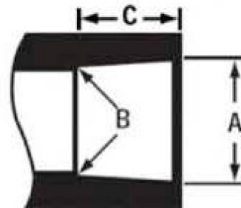

SCH 40 ASTM F438

SCH 80-ASTM F439

SIZE	Socket Ent. A	Socket Bottom B	Tolerance	SCH 40 Minimum Socket Length C	SCH 80 Minimum Socket Length C
3/4"	1.058	1.046	±0.004	0.719	1.000
1"	1.325	1.310	±0.005	0.875	1.125
1-1/4"	1.670	1.655	±0.005	0.938	1.250
1-1/2"	1.912	1.894	±0.006	1.094	1.375
2"	2.387	2.369	±0.005	1.156	1.500
2-1/2"	2.899	2.868	±0.007	1.75	1.750
3"	3.516	3.492	±0.008	1.875	1.875

System No.		Location		Spec Section		Paragraph	
Submitted By		Date		Approved		Date	

CPVC FITTING - TEE

SOCKET X SOCKET X SOCKET

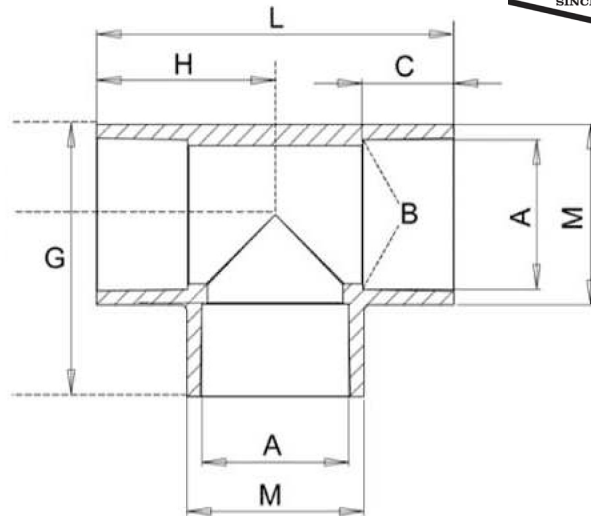

- Pressured Rated to 175 psi @ 150°F (1200kpa @ 65°C)
- Corrosion Resistant CPVC Material Does Not Sustain Biological Growth
- Superior Flow Characteristics
- 10 Year Limited Warranty



Part Number	Size	G	H	L	M	Approx Wt. (Lbs.)
CPT-34	3/4	28/43	1-31/68	2-7/8	1-5/16	0.11
CPT-1	1	3/4	1-5/8	3-3/16	1-5/8	0.19
CPT-114	1-1/4	15/16	1-7/8	3-25/32	1-31/32	0.28
CPT-112	1-1/2	1-15/79	2-25/44	5-1/8	2-11/32	0.65
CPT-2	2	1-32/93	2-15/16	5-7/8	2-7/8	1.00
CPT-212	2-1/2	1-23/32	3-1/2	7	3-15/32	1.60
CPT-3	3	2-1/16	3-15/16	7-7/8	4-3/16	3.02

SOCKET DIMENSIONS

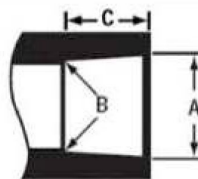

SCH 40 ASTM F438
SCH 80-ASTM F439

SIZE	Socket Ent. A	Socket Bottom B	Tolerance	SCH 40 Minimum Socket Length C	SCH 80 Minimum Socket Length C
3/4"	1.058	1.046	±0.004	0.719	1.000
1"	1.325	1.310	±0.005	0.875	1.125
1-1/4"	1.670	1.655	±0.005	0.938	1.250
1-1/2"	1.912	1.894	±0.006	1.094	1.375
2"	2.387	2.369	±0.005	1.156	1.500
2-1/2"	2.899	2.868	±0.007	1.75	1.750
3"	3.516	3.492	±0.008	1.875	1.875

System No.		Location		Spec Section		Paragraph	
Submitted By		Date		Approved		Date	

CPVC FITTING REDUCING TEE SOCKET X SOCKET X SOCKET

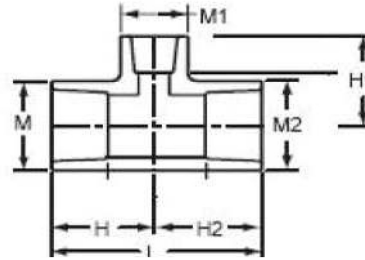

Part Number	Size	M	M2	M1	L	H	Approx Wt. (Lbs.)
CPRT-13434	1 X 3/4 X 3/4	1-4/33	1	1	3-19/48	1-35/48	0.14
CPRT-1341	1 X 3/4 X 1	1-5/8	1-5/8	1-5/8	3-5/32	1-5/8	0.26
CPRT1134	1 X 1 X 3/4	1-5/8	1-5/8	1-5/16	3-9/16	1-25/32	0.14
CPRT-34341	3/4 X 3/4 X 1	61/78	61/78	15/16	3-5/32	1-33/58	0.19
CPRT-114134	1-1/4 X 1 X 3/4	2-3/32	1-23/32	1-13/32	3-25/32	1-15/16	0.32
CPRT-11411434	1-1/4 X 1-1/4 X 3/4	1-16/69	1-16/69	1-5/16	3-53/66	1-82/91	0.21
CPRT-1141141	1-1/4 X 1-1/4 X 1	1-16/69	1-16/69	1-5/8	4-4/43	2-4/87	0.24
CPRT-114114112	1-1/4 X 1-1/4 X 1-1/2	1-16/69	1-16/69	2-11/32	4-3/4	2-3/8	0.51
CPRT-1141114	1-1/4 X 1 X 1-1/4	1-16/69	1-7/33	1-16/69	4-8/63	2-11/94	0.34
CPRT-114111	1-1/4 X 1 X 1	1-16/69	1-4/33	4/25	3-77/82	2-1/56	0.24
CPRT-11211434	1-1/2 X 1-1/4 X 3/4	2-5/16	2-1/16	1-3/8	4	2-1/16	0.41
CPRT-1121141	1-1/2 X 1-1/4 X 1	2-5/16	2-1/16	1-11/16	4-15/32	2-7/32	0.42
CPRT-11211234	1-1/2 X 1-1/2 X 3/4	2-5/16	2-5/16	1-3/8	4-3/16	2-3/32	0.38
CPRT-1121121	1-1/2 X 1-1/2 X 1	2-5/16	2-5/16	1-7/8	4-15/41	2-3/17	0.41
CPRT-112112114	1-1/2 X 1-1/2 X 1-1/4	2-5/16	2-5/16	2-1/16	5-5/41	2-23/41	0.52
CPRT-1121122	1-1/2 X 1-1/2 X 2	2-11/32	2-11/32	2-27/32	5-3/8	2-11/16	0.72
CPRT-2234	2 X 2 X 3/4	2-27/32	2-27/32	1-3/8	4-7/16	2-7/32	0.52
CPRT-221	2 X 2 X 1	2-27/32	2-27/32	1-7/8	4-5/7	2-17/49	0.56
CPRT-22114	2 X 2 X 1-1/4	2-27/32	2-27/32	2-1/16	5-1/16	2-17/49	0.62
CPRT-22112	2 X 2 X 1-1/2	2-27/32	2-27/32	2-3/8	5-6/7	2-13/14	0.78

SOCKET DIMENSIONS

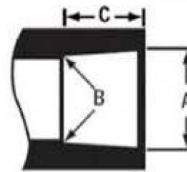

SCH 40 ASTM F438
SCH 80-ASTM F439

SIZE	Socket Ent. A	Socket Bottom B	Tolerance	SCH 40 Minimum Socket Length C	SCH 80 Minimum Socket Length C
3/4"	1.058	1.046	±0.004	0.719	1.000
1"	1.325	1.310	±0.005	0.875	1.125
1-1/4"	1.670	1.655	±0.005	0.938	1.250
1-1/2"	1.912	1.894	±0.006	1.094	1.375
2"	2.387	2.369	±0.005	1.156	1.500
2-1/2"	2.899	2.868	±0.007	1.75	1.750
3"	3.516	3.492	±0.008	1.875	1.875

System No.		Location		Spec Section		Paragraph	
Submitted By		Date		Approved		Date	

CPVC FITTING REDUCER BUSHING FLUSH STYLE SPIGOT X SOCKET

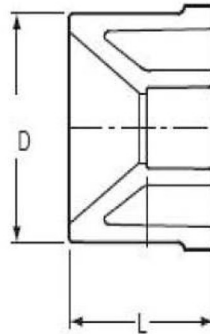

- Pressured Rated to 175 psi @ 150°F (1200kpa @ 65°C)
- Corrosion Resistant CPVC Material Does Not Sustain Biological Growth
- Superior Flow Characteristics
- 10 Year Limited Warranty



Part Number	Size	L	D (Fitting) (Inside Dia.)	Approx Wt. (Lbs.)
CPB-134	1 X 3/4	1-13/32	1.315 ±0.010	0.05
CPB-11434	1-1/4 X 3/4	1-3/8	1.660 ±0.012	0.12
CPB-1141	1-1/4 X 1	1-3/8	1.660 ±0.012	0.09
CPB-11234	1-1/2 X 3/4	1-23/32	1.900 ±0.012	0.19
CPB-1121	1-1/2 X 1	1-23/32	1.900 ±0.012	0.15
CPB-112114	1-1/2 X 1-1/4	1-23/32	1.900 ±0.012	0.09
CPB-234	2 X 3/4	1-29/32	2.375 ±0.012	0.22
CPB-21	2 X 1	1-29/32	2.375 ±0.012	0.27
CPB-2114	2 X 1-1/4	1-29/32	2.375 ±0.012	0.24
CPB-2112	2 X 1-1/2	1-29/32	2.375 ±0.012	0.18

SOCKET DIMENSIONS

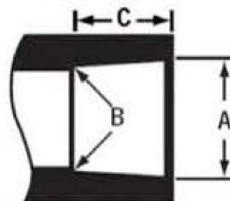

SCH 40 ASTM F438
SCH 80-ASTM F439

SIZE	Socket Ent. A	Socket Bottom B	Tolerance	SCH 40 Minimum Socket Length C	SCH 80 Minimum Socket Length C
3/4"	1.058	1.046	±0.004	0.719	1.000
1"	1.325	1.310	±0.005	0.875	1.125
1-1/4"	1.670	1.655	±0.005	0.938	1.250
1-1/2"	1.912	1.894	±0.006	1.094	1.375
2"	2.387	2.369	±0.005	1.156	1.500
2-1/2"	2.899	2.868	±0.007	1.75	1.750
3"	3.516	3.492	±0.008	1.875	1.875

System No.		Location		Spec Section		Paragraph	
Submitted By		Date		Approved		Date	

CPVC FITTING - CROSS SOCKET X SOCKET X SOCKET X SOCKET

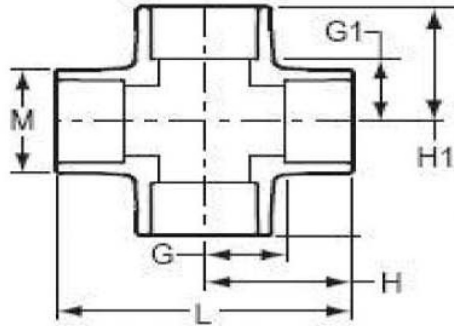

- Pressured Rated to 175 psi @ 150°F (1200kpa @ 65°C)
- Corrosion Resistant CPVC Material Does Not Sustain Biological Growth
- Superior Flow Characteristics
- 10 Year Limited Warranty



(UL Listed for up to 1")

Part Number	Size	G	H	L	G1	H1	M	Approx Wt. (Lbs.)
CPCRS-34	3/4	5/8	1-10/29	2-11/16	5/8	1-10/29	1-13/32	0.22
CPCRS-1	1	3/4	1-5/8	3-11/16	1-11/16	1-5/8	1-5/8	0.23
CPCRS-114	1-1/4	15/16	1-7/8	3-11/16	1-1/8	1-7/8	2-3/32	0.65
CPCRS-112	1-1/2	1-7/32	2-5/8	5-1/4	1-7/32	2-5/8	2-11/32	0.87
CPCRS-2	2	1-1/2	3	6	1-1/2	3	3	1.43

SOCKET DIMENSIONS

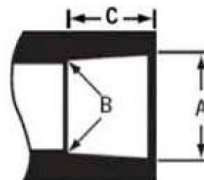

SCH 40 ASTM F438
SCH 80-ASTM F439

SIZE	Socket Ent. A	Socket Bottom B	Tolerance	SCH 40 Minimum Socket Length C	SCH 80 Minimum Socket Length C
3/4"	1.058	1.046	±0.004	0.719	1.000
1"	1.325	1.310	±0.005	0.875	1.125
1-1/4"	1.670	1.655	±0.005	0.938	1.250
1-1/2"	1.912	1.894	±0.006	1.094	1.375
2"	2.387	2.369	±0.005	1.156	1.500
2-1/2"	2.899	2.868	±0.007	1.75	1.750
3"	3.516	3.492	±0.008	1.875	1.875

System No.		Location		Spec Section		Paragraph	
Submitted By		Date		Approved		Date	

CPVC FITTING - ADAPTER GROOVE X SOCKET

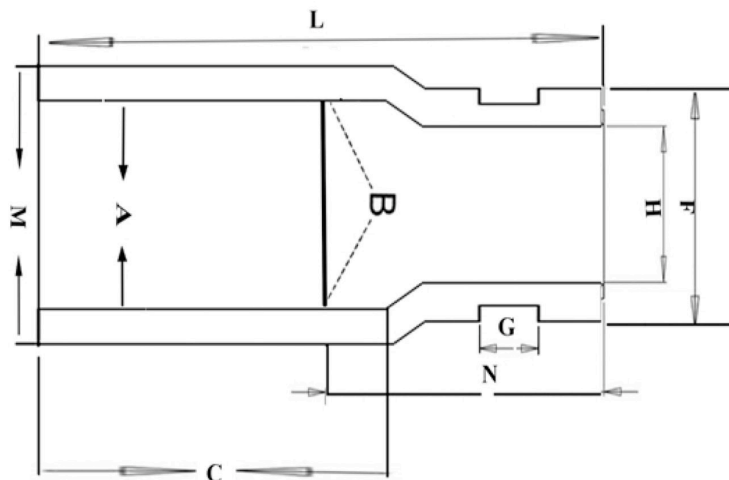

- Pressured Rated to 175 psi @ 150°F (1200kpa @ 65°C)
- Corrosion Resistant CPVC Material Does Not Sustain Biological Growth
- Superior Flow Characteristics
- 10 Year Limited Warranty



 (UL Listed for up to 1")



Part Number	Size	L	N	M	G	H	F	Approx Wt. (Lbs.)
CPGRV-114	1-1/4	3.000	1.4655	2.088	0.307	1.246	1.660	0.12
CPGRV-112	1-1/2	3.160	1.4980	2.347	0.307	1.456	1.895	0.21
CPGRV-2	2	3.396	1.536	2.869	0.307	1.881	2.379	0.32
CPGRV-212	2-1/2	3.650	1.562	3.453	0.307	2.252	2.872	0.59

SOCKET DIMENSIONS

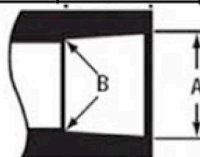

SCH 40 ASTM F438
SCH 80-ASTM F439

SIZE	Socket Ent. A	Socket Bottom B	Tolerance	SCH 40 Minimum Socket Length C	SCH 80 Minimum Socket Length C
3/4"	1.058	1.046	±0.004	0.719	1.000
1"	1.325	1.310	±0.005	0.875	1.125
1-1/4"	1.670	1.655	±0.005	0.938	1.250
1-1/2"	1.912	1.894	±0.006	1.094	1.375
2"	2.387	2.369	±0.005	1.156	1.500
2-1/2"	2.899	2.868	±0.007	1.75	1.750
3"	3.516	3.492	±0.008	1.875	1.875

System No.		Location		Spec Section		Paragraph	
Submitted By		Date		Approved		Date	

CPVC FITTING - ADAPTER FEMALE BRASS THREAD X SOCKET

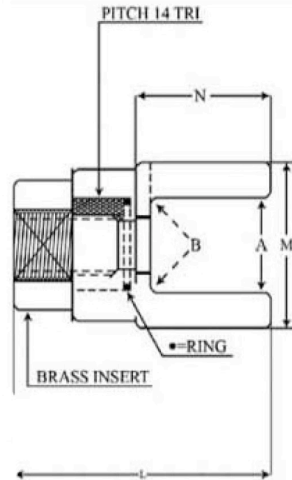

- Pressured Rated to 175 psi @ 150°F (1200kpa @ 65°C)
- Corrosion Resistant CPVC Material Does Not Sustain Biological Growth
- Superior Flow Characteristics
- 10 Year Limited Warranty

FM APPROVED cULus
(UL Listed for up to 1")



PART	SIZE	L	M	N	Wall Thickness	Approx Wt. (Lbs.)
CPFHA-3412B	3/4 X 1/2	2-11/78	N/A	N/A	0.365	0.20
CPFHA-112B	1 X 1/2	2-6/19	N/A	N/A	0.396	0.15
CPFHA-3412P	3/4 X 1/2	2-1/25	1.046±0.004	1.000±0.004	0.396	0.13
CPFHA-112P	1 X 1/2	1-8/11	1.310±0.004	1.051±0.004	0.396	0.12
CPFHA-134B	1 X 3/4	2.448	1.722	1.675	0.396	0.30

SOCKET DIMENSIONS

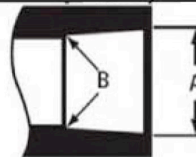

SCH 40 ASTM F438
SCH 80-ASTM F439

SIZE	Socket Ent. A	Socket Bottom B	Tolerance	SCH 40 Minimum Socket Length C	SCH 80 Minimum Socket Length C
3/4"	1.058	1.046	±0.004	0.719	1.000
1"	1.325	1.310	±0.005	0.875	1.125
1-1/4"	1.670	1.655	±0.005	0.938	1.250
1-1/2"	1.912	1.894	±0.006	1.094	1.375
2"	2.387	2.369	±0.005	1.156	1.500
2-1/2"	2.899	2.868	±0.007	1.75	1.750
3"	3.516	3.492	±0.008	1.875	1.875

System No.		Location		Spec Section		Paragraph	
Submitted By		Date		Approved		Date	

CPVC FITTING - ADAPTER FEMALE BRASS THREAD X SOCKET

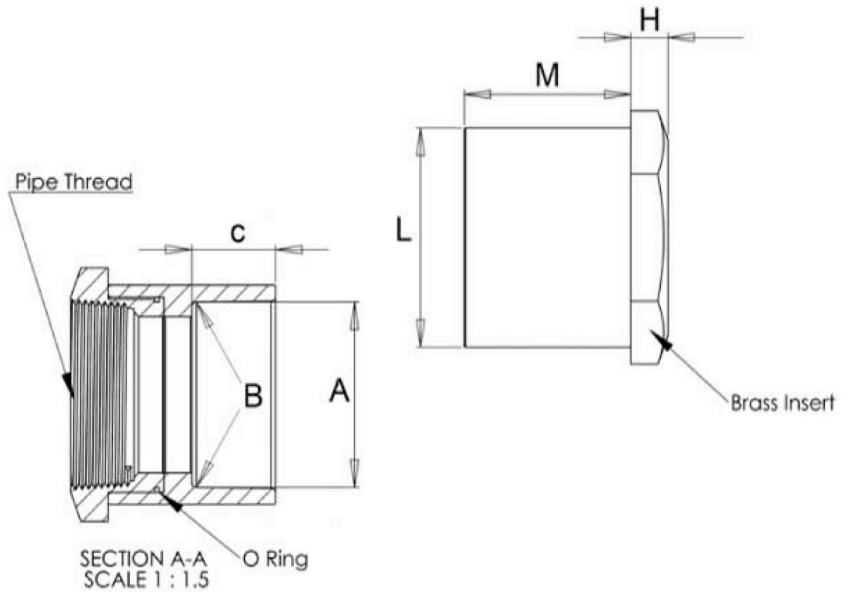

- Pressured Rated to 175 psi @ 150°F (1200kpa @ 65°C)
- Corrosion Resistant CPVC Material Does Not Sustain Biological Growth
- Superior Flow Characteristics
- 10 Year Limited Warranty



Part No.	Size	M	L	H	Approx Wt. (Lbs.)
CPFA-34	3/4	1-3/8	1-3/8	1/2	0.30
CPFA-1	1	2	1-3/4	1/2	0.38
CPFA-114	1-1/4	2-13/89	2-1/4	1/2	0.35
CPFA-112	1-1/2	2-27/86	2-19/50	1/2	0.47
CPFA-2	2	2-39/98	2-17/20	1/2	1.14

SOCKET DIMENSIONS

SCH 40 ASTM F438
SCH 80-ASTM F439

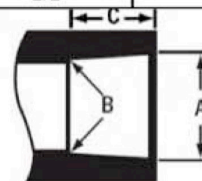

SIZE	Socket Ent. A	Socket Bottom B	Tolerance	SCH 40 Minimum Socket Length C	SCH 80 Minimum Socket Length C
3/4"	1.058	1.046	±0.004	0.719	1.000
1"	1.325	1.310	±0.005	0.875	1.125
1-1/4"	1.670	1.655	±0.005	0.938	1.250
1-1/2"	1.912	1.894	±0.006	1.094	1.375
2"	2.387	2.369	±0.005	1.156	1.500
2-1/2"	2.899	2.868	±0.007	1.75	1.750
3"	3.516	3.492	±0.008	1.875	1.875

System No.		Location		Spec Section		Paragraph	
Submitted By		Date		Approved		Date	

CPVC FITTING - EXTENSION FEMALE BRASS THREAD X SOCKET

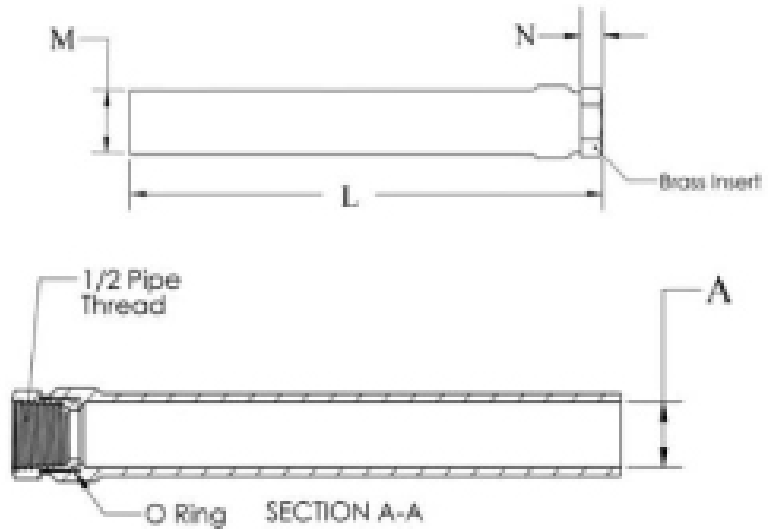

- Pressured Rated to 175 psi @ 150°F (1200kpa @ 65°C)
- Corrosion Resistant CPVC Material Does Not Sustain Biological Growth
- Superior Flow Characteristics
- 10 Year Limited Warranty



Part Number	Size	L	M	N	A	Approx Wt. (Lbs.)
CPFHAX-112B	1 X 1/2	8	1-19/59	3/8	1-1/11	0.25
CPFHAX-3412B	3/4 X 1/2	8	1-3/79	3/8	43/50	0.20
CPFHAX-112P	1 X 1/2	8	1-19/59	3/8	1-1/11	0.20
CPFHAX-3412P	3/4 X 1/2	8	1-3/79	3/8	43/50	0.15

SOCKET DIMENSIONS

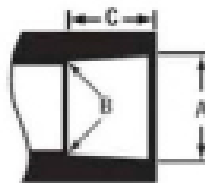

SCH 40 ASTM F438
SCH 80-ASTM F439

SIZE	Socket Ent. A	Socket Bottom B	Tolerance	SCH 40 Minimum Socket Length C	SCH 80 Minimum Socket Length C
3/4"	1.058	1.046	±0.004	0.719	1.000
1"	1.325	1.310	±0.005	0.875	1.125
1-1/4"	1.670	1.655	±0.005	0.938	1.250
1-1/2"	1.912	1.894	±0.006	1.094	1.375
2"	2.387	2.369	±0.005	1.156	1.500
2-1/2"	2.899	2.868	±0.007	1.75	1.750
3"	3.516	3.492	±0.008	1.875	1.875

System No.		Location		Spec Section		Paragraph	
Submitted By		Date		Approved		Date	

CPVC FITTING - ADAPTER TEE FEMALE BRASS IPT X SOCKET X SOCKET

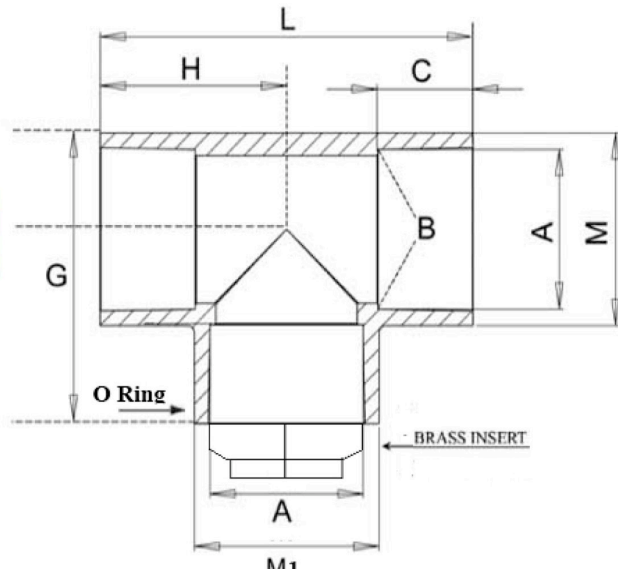

- Pressured Rated to 175 psi @ 150°F (1200kpa @ 65°C)
- Corrosion Resistant CPVC Material Does Not Sustain Biological Growth
- Superior Flow Characteristics
- 10 Year Limited Warranty



Part Number	Size	G	H	L	M1	M	Approx Wt. (Lbs.)
CPT-1112B	1X1X1/2	2.186	1.556	3.112	1.339	1.695	0.26
CPT-1134B	1X1X3/4	2.188	1.556	3.112	1.481	1.695	0.39

SOCKET DIMENSIONS

SCH 40 ASTM F438
SCH 80-ASTM F439

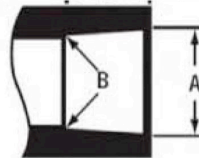

SIZE	Socket Ent. A	Socket Bottom B	Tolerance	SCH 40 Minimum Socket Length C	SCH 80 Minimum Socket Length C
3/4"	1.058	1.046	±0.004	0.719	1.000
1"	1.325	1.310	±0.005	0.875	1.125
1-1/4"	1.670	1.655	±0.005	0.938	1.250
1-1/2"	1.912	1.894	±0.006	1.094	1.375
2"	2.387	2.369	±0.005	1.156	1.500
2-1/2"	2.899	2.868	±0.007	1.75	1.750
3"	3.516	3.492	±0.008	1.875	1.875

System No.		Location		Spec Section		Paragraph	
Submitted By		Date		Approved		Date	

CPVC FITTING - ADAPTER 90 FEMALE BRASS IPT X SOCKET

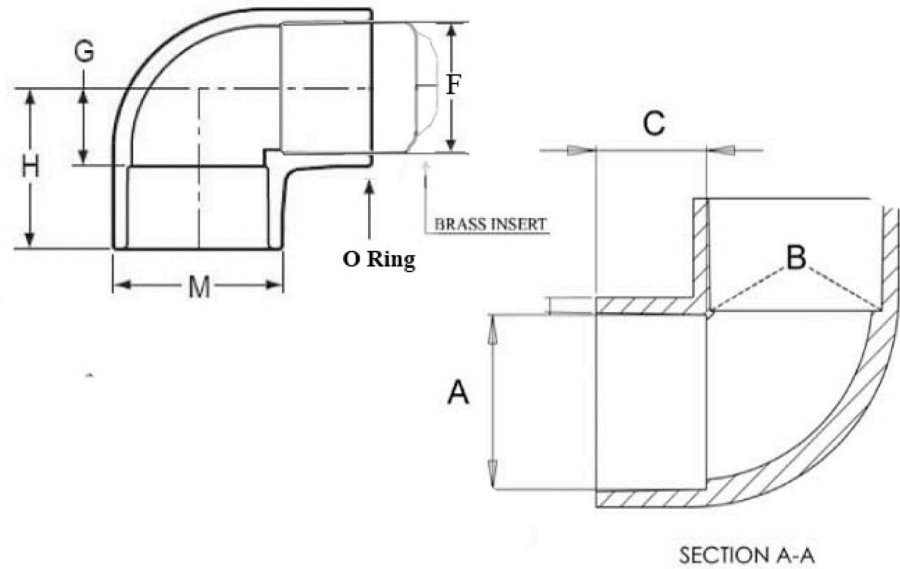

- Pressured Rated to 175 psi @ 150°F (1200kpa @ 65°C)
- Corrosion Resistant CPVC Material Does Not Sustain Biological Growth
- Superior Flow Characteristics
- 10 Year Limited Warranty



Part Number	Size	G	H	M	F	Approx Wt. (Lbs.)
CP90-112B	1 X 1/2	0.730	1.460	1.700	1.337	0.22
CP90-134B	1 X 3/4	0.730	1.460	1.700	1.490	0.35

SOCKET DIMENSIONS

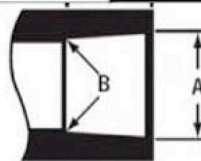

SCH 40 ASTM F438
SCH 80-ASTM F439

SIZE	Socket Ent. A	Socket Bottom B	Tolerance	SCH 40 Minimum Socket Length C	SCH 80 Minimum Socket Length C
3/4"	1.058	1.046	±0.004	0.719	1.000
1"	1.325	1.310	±0.005	0.875	1.125
1-1/4"	1.670	1.655	±0.005	0.938	1.250
1-1/2"	1.912	1.894	±0.006	1.094	1.375
2"	2.387	2.369	±0.005	1.156	1.500
2-1/2"	2.899	2.868	±0.007	1.75	1.750
3"	3.516	3.492	±0.008	1.875	1.875

System No.		Location		Spec Section		Paragraph	
Submitted By		Date		Approved		Date	

CPVC FITTING - ADAPTER

FEMALE BRASS THREAD SPIGOT ADAPTER

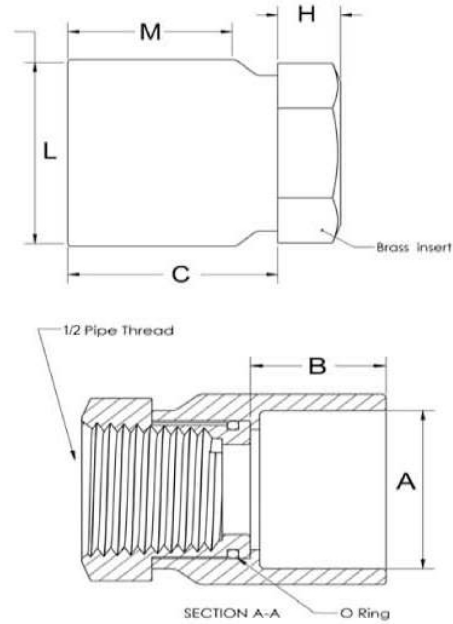

- Pressured Rated to 175 psi @ 150°F (1200kpa @ 65°C)
- Corrosion Resistant CPVC Material Does Not Sustain Biological Growth
- Superior Flow Characteristics
- 10 Year Limited Warranty



Part Number	Size	A	C	H	L	M	Approx Wt. (Lbs.)
CPFTSA-34B	3/4x1/2	0	0	0	0	0	0.00
CPFTSA-1B	1x1/2	1-1/11	46/63	3/8	1-10/37	1	0.00

SOCKET DIMENSIONS

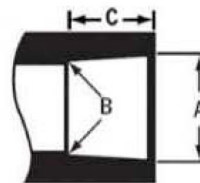

SCH 40 ASTM F438
SCH 80-ASTM F439

SIZE	Socket Ent. A	Socket Bottom B	Tolerance	SCH 40 Minimum Socket Length C	SCH 80 Minimum Socket Length C
3/4"	1.058	1.046	±0.004	0.719	1.000
1"	1.325	1.310	±0.005	0.875	1.125
1-1/4"	1.670	1.655	±0.005	0.938	1.250
1-1/2"	1.912	1.894	±0.006	1.094	1.375
2"	2.387	2.369	±0.005	1.156	1.500
2-1/2"	2.899	2.868	±0.007	1.75	1.750
3"	3.516	3.492	±0.008	1.875	1.875

System No.		Location		Spec Section		Paragraph	
Submitted By		Date		Approved		Date	



PIPING TOOLS
FIRE SPRINKLER SPECIALTIES
FIRE EQUIPMENT
PIPING CHEMICALS
HANGERS & FASTENERS
PIPE JOINING
VALVES
BOILER SPECIALTIES

800.854.1015 **argco.com**