



ARGCO's line of Ductile Iron Threaded Fittings conform to, comply with the following standards:

ASTM A536 Grade 65-45-12

ASME B 16.3 Ductile Iron Threaded Fittings Class 150

ANSI/ASME B1.20.1 Pipe Threads, General Purpose (inch) NPT

## **DUCTILE IRON THREADED FITTINGS CATALOG**

**ARGCO SALES:** toll free: 800-854-1015

[argco.com](http://argco.com)

international: 760-727-1644 | fax: 800-924-5922

email: [info@argco.com](mailto:info@argco.com)

**ARGCO**

# DUCTILE IRON THREADED FITTINGS



Dimensions: ANSI B16.3 CLASS 150

- Material: Ductile Iron per ASTM A536 Grade 65-45-12
- Coating: Black
- Threads: Pipe Threads, General Purpose ASME B1.20.1

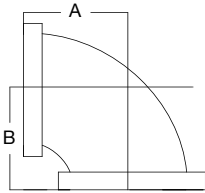

## 90 DEGREE ELBOW

Item #	Size	A	B	Weight
<a href="#">7110000</a>	1"	1.5	1.5	0.62
<a href="#">7110001</a>	1-1/4"	1.75	1.75	0.90
<a href="#">7110002</a>	1-1/2"	1.94	1.94	1.20
<a href="#">7110003</a>	2"	2.25	2.25	1.85

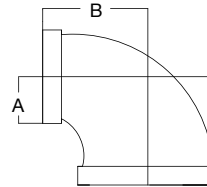

## 90 DEGREE REDUCING ELBOW

Item #	Size	A	B	Weight
<a href="#">7110080</a>	1" x 1/2"	1.25	1.36	0.44
<a href="#">7110081</a>	1" x 3/4"	1.37	1.45	0.52
<a href="#">7110082</a>	1-1/4" x 1/2"	1.34	1.53	0.64
<a href="#">7110083</a>	1-1/4" x 3/4"	1.45	1.62	0.72
<a href="#">7110084</a>	1-1/4" x 1"	1.58	1.67	0.75
<a href="#">7110085</a>	1-1/2" x 1"	1.65	1.80	0.92
<a href="#">7110086</a>	1-1/2" x 1-1/4"	1.82	1.88	1.08
<a href="#">7110087</a>	2" x 1/2"	1.49	1.88	1.08
<a href="#">7110088</a>	2" x 3/4"	1.60	1.97	1.24
<a href="#">7110089</a>	2" x 1"	1.73	2.02	1.40
<a href="#">7110090</a>	2" x 1-1/4"	1.90	2.10	1.52
<a href="#">7110091</a>	2" x 1-1/2"	2.02	2.16	1.65

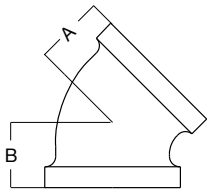

## 45 DEGREE ELBOW

Item #	Size	A	B	Weight
<a href="#">7110006</a>	1"	1.12	1.12	0.48
<a href="#">7110007</a>	1-1/4"	1.29	1.29	0.73
<a href="#">7110008</a>	1-1/2"	1.43	1.43	0.92
<a href="#">7110009</a>	2"	1.68	1.66	1.50

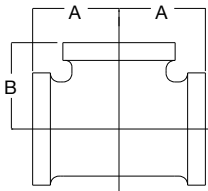

## STRAIGHT TEE

Item #	Size	A	B	Weight
<a href="#">7110012</a>	1"	1.5	1.5	0.85
<a href="#">7110013</a>	1-1/4"	1.75	1.75	1.22
<a href="#">7110014</a>	1-1/2"	1.94	1.94	1.55
<a href="#">7110015</a>	2"	2.25	2.25	1.45

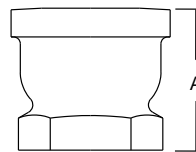

## REDUCING COUPLING

Item #	Size	A	Weight
<a href="#">7110022</a>	1" x 1/2"	1.5	0.39
<a href="#">7110023</a>	1" x 3/4"	1.75	0.53

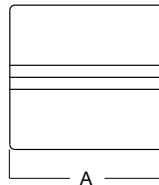

## COUPLING

Item #	Size	A	Weight
<a href="#">7110018</a>	1"	1.5	0.85
<a href="#">7110019</a>	1-1/4"	1.75	1.22
<a href="#">7110020</a>	1-1/2"	1.94	1.55
<a href="#">7110021</a>	2"	2.25	2.25

# DUCTILE IRON THREADED FITTINGS

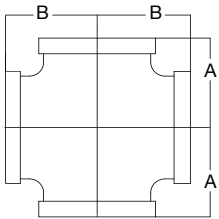

## CROSS

Item #	Size	A	B	Weight
<a href="#">7110094</a>	1"	1.50	1.50	0.98
<a href="#">7110095</a>	1-1/4" x 1"	1.58	1.58	1.27
<a href="#">7110096</a>	1-1/2" x 1"	1.65	1.65	1.45
<a href="#">7110097</a>	2" x 1"	1.73	1.73	2.10
<a href="#">7110098</a>	1-1/4"	1.75	1.75	1.50
<a href="#">7110099</a>	1-1/2"	1.94	1.94	1.90
<a href="#">7110100</a>	2"	2.25	2.25	2.95

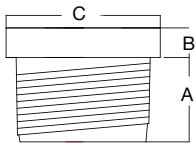

## BUSHING

Item #	Size	A	B	C	Weight
<a href="#">7110103</a>	1" x 1/2"	0.75	0.25	1.42	0.22
<a href="#">7110104</a>	1" x 3/4"	0.75	0.25	1.42	0.17
<a href="#">7110105</a>	1-1/4" x 1"	0.80	0.28	1.76	1.28
<a href="#">7110106</a>	1-1/2" x 1"	0.83	0.31	2.00	0.44
<a href="#">7110107</a>	1-1/2" x 1-1/4"	0.83	0.31	2.00	0.30
<a href="#">7110108</a>	2" x 1"	0.88	0.41	1.95	0.66
<a href="#">7110109</a>	2" x 1-1/4"	0.88	0.34	2.48	0.72
<a href="#">7110110</a>	2" x 1-1/2"	0.88	0.34	2.48	0.61

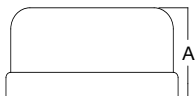

## CAP

Item #	Size	A	Weight
<a href="#">7110113</a>	1"	1.16	0.32
<a href="#">7110114</a>	1-1/4"	1.28	0.43
<a href="#">7110115</a>	1-1/2"	1.33	0.60
<a href="#">7110116</a>	2"	1.45	0.91

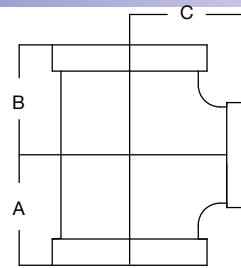

## REDUCING TEE

Item #	Size	A	B	C	Weight
<a href="#">7110026</a>	1" x 1/2" x 1"	1.50	1.36	1.50	0.71
<a href="#">7110027</a>	1" x 3/4" x 1"	1.50	1.45	1.50	0.76
<a href="#">7110028</a>	1" x 1" x 1/2"	1.26	1.26	1.36	0.73
<a href="#">7110029</a>	1" x 1" x 3/4"	1.37	1.37	1.45	0.73
<a href="#">7110030</a>	1" x 1" x 1-1/2"	1.80	1.80	1.65	1.16
<a href="#">7110030A</a>	1" x 1" x 1-1/4"	1.67	1.67	1.58	0.98
<a href="#">7110031</a>	1-1/4" x 1" x 1/2"	1.34	1.26	1.53	0.82
<a href="#">7110032</a>	1-1/4" x 1" x 3/4"	1.45	1.37	1.62	0.90
<a href="#">7110033</a>	1-1/4" x 1" x 1"	1.58	1.50	1.67	1.00
<a href="#">7110034</a>	1-1/4" x 1" x 1-1/4"	1.75	1.67	1.75	1.08
<a href="#">7110035</a>	1-1/4" x 1" x 1-1/2"	1.88	1.88	1.82	1.42
<a href="#">7110036</a>	1-1/4" x 1-1/4" x 1/2"	1.34	1.34	1.53	0.86
<a href="#">7110037</a>	1-1/4" x 1-1/4" x 3/4"	1.45	1.45	1.62	0.92
<a href="#">7110038</a>	1-1/4" x 1-1/4" x 1"	1.58	1.58	1.67	0.95
<a href="#">7110039</a>	1-1/4" x 1-1/4" x 1-1/2"	1.88	1.88	1.82	1.45
<a href="#">7110041</a>	1-1/2" x 1" x 1/2"	1.41	1.34	1.66	0.95
<a href="#">7110042</a>	1-1/2" x 1" x 3/4"	1.52	1.37	1.75	1.14
<a href="#">7110043</a>	1-1/2" x 1" x 1"	1.65	1.50	1.80	1.17
<a href="#">7110045</a>	1-1/2" x 1" x 1-1/2"	1.94	1.80	1.94	1.45
<a href="#">7110046</a>	1-1/2" x 1-1/4" x 1/2"	1.41	1.34	1.66	1.05
<a href="#">7110047</a>	1-1/2" x 1-1/4" x 3/4"	1.52	1.45	1.75	1.15
<a href="#">7110048</a>	1-1/2" x 1-1/4" x 1"	1.65	1.58	1.80	1.25
<a href="#">7110050</a>	1-1/2" x 1-1/2" x 1/2"	1.41	1.41	1.16	1.15
<a href="#">7110051</a>	1-1/2" x 1-1/2" x 3/4"	1.52	1.52	1.75	1.24
<a href="#">7110052</a>	1-1/2" x 1-1/2" x 1"	1.65	1.65	1.80	1.30
<a href="#">7110053</a>	1-1/2" x 1-1/2" x 1-1/4"	1.82	1.82	1.88	1.48
<a href="#">7110055</a>	2" x 1" x 2"	2.25	2.02	2.25	2.15
<a href="#">7110056</a>	2" x 1-1/4" x 2"	2.25	2.10	2.25	2.30
<a href="#">7110057</a>	2" x 1-1/2" x 1/2"	1.49	1.41	1.88	1.50
<a href="#">7110058</a>	2" x 1-1/2" x 3/4"	1.60	1.52	1.97	1.62
<a href="#">7110059</a>	2" x 1-1/2" x 1"	1.73	1.65	2.02	1.64
<a href="#">7110060</a>	2" x 1-1/2" x 1-1/4"	1.90	1.82	2.10	1.80
<a href="#">7110061</a>	2" x 1-1/2" x 1-1/2"	2.02	1.94	2.16	2.00
<a href="#">7110062</a>	2" x 1-1/2" x 2"	2.25	2.16	2.25	2.35
<a href="#">7110063</a>	2" x 2" x 1/2"	1.49	1.49	1.88	1.60
<a href="#">7110064</a>	2" x 2" x 3/4"	1.60	1.60	1.97	1.68
<a href="#">7110065</a>	2" x 2" x 1"	1.73	1.73	2.02	1.85
<a href="#">7110066</a>	2" x 2" x 1-1/4"	1.90	1.90	2.10	2.04
<a href="#">7110067</a>	2" x 2" x 1-1/2"	2.02	2.02	2.16	2.18



**ARGCO.com**

For more products, pricing, technical data, SDS, log onto: [www.argco.com](http://www.argco.com)

**ARGCO SALES:** toll free: 800-854-1015  
international: 760-727-1644 | fax: 800-924-5922  
email: [info@argco.com](mailto:info@argco.com)

**ARGCO**