

### CLEVIS HANGER LIGHT DUTY - COPPER EPOXY COATED

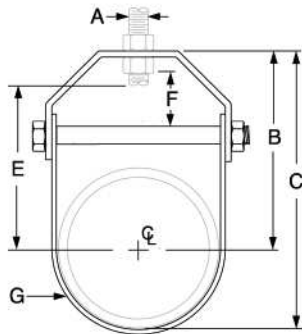

**FINISH:**

Copper-Colored Epoxy (PC)

**FUNCTION:**

Allows vertical adjustment of pipe after installation

**FEATURES:**

- Maximum temperature Plain 650° F, Galvanized 450° F
- Conforms with Federal Specification WW-H-171 (Type 1), Manufacturers Standardization Society (MSS) SP-69 (Type 1)
- When using an oversize clevis, it is recommended to install a full-width spacer on the cross bolt to prevent failure due to disfiguring the U-strap
- When using insulated pipe, order hanger sized to correspond to overall dimension. It is also recommended to use insulation shields

**Light Duty Clevis Hanger - PC: Loads (LBS) • Weights (LBS) • Dimensions (IN)**

ITEM CODE 4400	TUBE SIZE	MAX LOAD	WEIGHT	A ROD SIZE	B	C	E ROD TAKE OUT	F ADJUSTMENT
4400-0050PC	½	150	0.09	⅜	1 <sup>5</sup> / <sub>16</sub>	2¼	1⅞	⅜
4400-0075PC	¾	150	0.10	⅜	1½	1 <sup>15</sup> / <sub>16</sub>	1⅞	7/ <sub>16</sub>
4400-0100PC	1	250	0.14	⅜	1¾	2 <sup>5</sup> / <sub>16</sub>	1 <sup>15</sup> / <sub>16</sub>	9/ <sub>16</sub>
4400-0125PC	1¼	250	0.15	⅜	2 <sup>1</sup> / <sub>16</sub>	2¾	1 <sup>9</sup> / <sub>16</sub>	9/ <sub>16</sub>
4400-0150PC	1½	250	0.15	⅜	2 <sup>7</sup> / <sub>16</sub>	3 <sup>5</sup> / <sub>16</sub>	2 <sup>1</sup> / <sub>16</sub>	1 <sup>5</sup> / <sub>16</sub>
4400-0200PC	2	250	0.17	⅜	3 <sup>7</sup> / <sub>16</sub>	4½	3 <sup>3</sup> / <sub>8</sub>	1¾
4400-0250PC	2½	350	0.28	⅜	4½	5 <sup>11</sup> / <sub>16</sub>	3 <sup>15</sup> / <sub>16</sub>	2 <sup>1</sup> / <sub>8</sub>
4400-0300PC	3	350	0.57	⅜	3 <sup>5</sup> / <sub>8</sub>	5 <sup>3</sup> / <sub>16</sub>	4	2 <sup>1</sup> / <sub>16</sub>
4400-0400PC	4	400	0.73	⅜	3 <sup>5</sup> / <sub>16</sub>	7 <sup>3</sup> / <sub>8</sub> "	3 <sup>3</sup> / <sub>8</sub>	2 <sup>1</sup> / <sub>8</sub>

**FOR MORE INFORMATION CALL ARGCO AT 1-800-854-1015  
OR LOG ONTO WWW.ARGCO.COM**