

FIRE DEPARTMENT CONNECTIONS (SIAMESE)



2-Way Straight Pattern Single Clapper Complete

6510200/COMPCP

4" (100mm) NPT x 2.5" (65mm) hose thread x 2.5" hose thread

Straight body exposed fire department connection.

UL / ULC Listed and FM Approved

Swing clapper body that is used as an auxiliary connection and allows up to 500 GPM to supplement the system water supply for fire protection.

The swing clapper provides unobstructed waterway and the exposed design is an economical method of satisfying fire department inlet requirements.

Specify regional hose thread for outlet.

FINISH: Cast Chrome

WEIGHT: 12.5 lbs

OPTIONS: Polish Brass, Cast Brass or Polish Chrome

HOSE THREADS AVAILABLE: CSA, BCT, WCT, QST, NSST, NPSH, NST, Louisville, Cleveland, Chicago, Pittsburgh, New Cincinnati, New York Corp., New York Fire Department, Richmond and Raleigh

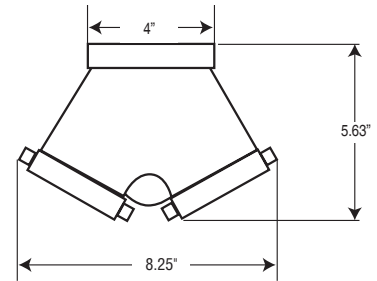

System No.		Location		Spec Section		Paragraph	
Submitted By		Date		Approved		Date	